

Çekmeceli Klemens Plug & Socket Terminals

Çekmeceli klemensler makina ekipman, pano ve diğer modüler sistemlerin elektrik bağlantılarında kullanılır.

Plug and socket terminals are used to make electric connections of machines, equipments and other disconnectable systems such as panel boards.

CKP 2/10 410 110

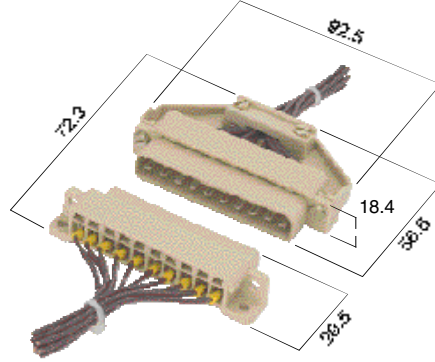

Anma Değerleri / Electrical Ratings	Gerilim / Akım / Kesit / Voltage/Current/Cross-section		
(EN 60998-1)	380 V ~ / 24 A / 4 mm ²		
Kablo Soyma Boyu / Insulation Stripping Length	9 mm		
Sipariş Bilgileri / Ordering Data	Tip/Type	Sip.No./Cat.No.	Mik./Qty.
Polyamide 6.6	CKP 2/10 Komple / Complete	410 110	10
	Fiş / Seperate Plug	410 120	10
	Soket / Seperate Socket	410 130	10

Cihaz Sıra Klemensleri Terminal Strips

PSK 1

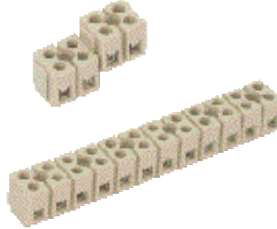

PSK 2



Anma Değerleri / Electrical Ratings	Gerilim / Akım / Kesit / Voltage/Current/Cross-section			Gerilim / Akım / Kesit / Voltage/Current/Cross-section		
TSE (EN 60998-2-1)	380 V ~ / 24 A / 2.5 mm ²			660 V ~ / 41 A / 6 mm ²		
(IEC 60998-1, IEC 60998-2-1)						
Kablo Soyma Boyu / Insulation Stripping Length	5 mm			9 mm		
Sipariş Bilgileri / Ordering Data	Tip/Type	Sip.No./Cat.No.	Mik./Qty.	Tip/Type	Sip.No./Cat.No.	Mik./Qty.
Geçmeli Tip / Can be joined end to end	PSK 1/2 (2'lil)	420 020	100	PSK 2/2 (2'lil)	421 020	100
	PSK 1/12 (12'lil)	420 120	75	PSK 2/10 (10'lil)	421 100	30

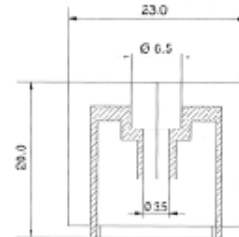
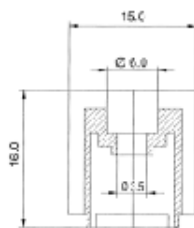

Sıra Klemensler

Terminal Strips

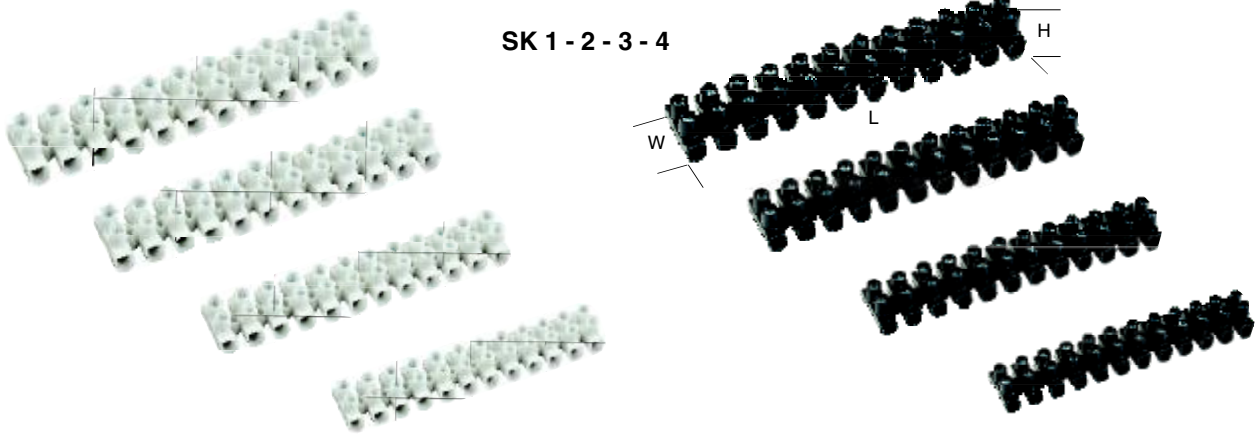

Anma Değerleri / Electrical Ratings	Gerilim / Kesit / Voltage/Cross-section											
IEC 60998-1, IEC 60998-2-1 (VDE)	450 V / 24 A / 2,5 mm ²	450 V / 32 A / 4 mm ²	450 V / 41 A / 6 mm ²	450 V / 76 A / 10 mm ²								
UL / UL	300 V / 20 A / AWG 22 - 12	300 V / 30 A / AWG 22 - 10	300 V / 50 A / AWG 14 - 8	300 V / 55 A / AWG 10 - 6								
Bağlantı Bilgileri / Connection Data												
Tekli İletken, Vida Bağlantılı / Solid Strand, Screw Connection	0,75 - 2,5 mm ²	0,75 - 4 mm ²	0,75 - 6 mm ²	0,75 - 10 mm ²								
Çoklu İletken, Vida Bağlantılı / Fine Strand, Screw Connection	1,5 - 1,5 mm ²	1,5 - 2,5 mm ²	1,5 - 4 mm ²	1,5 - 6 mm ²								
Sipariş Bilgileri / Ordering Data	Tip/Type	Sip.No./Cat.No.	Mik./Qty.	Tip/Type	Sip.No./Cat.No.	Mik./Qty.	Tip/Type	Sip.No./Cat.No.	Mik./Qty.	Tip/Type	Sip.No./Cat.No.	Mik./Qty.
Siyah (Vida Blokajı, Pasivasyonu) Black (With Screw Blockage, Passivated)	SK 1	430 002	50	SK 2	430 012	50	SK 3	430 022	50	SK 4	430 032	50
Ebatlar Dimensions	L: 95	W:16	H:12,8	L: 116	W:19	H:15	L: 135	W:22,5	H:17,65	L: 176	W:25,3	H:20,5
Naturel (Vida Blokajı, Nikel Kaplı) White (With Screw Blockage, Ni Coated)	SK 1	431 002	50	SK 2	431 012	50	SK 3	431 022	50	SK 4	431 032	50

Buat Klemensleri

Junction Box Terminals

- 1,5 - 2,5 mm² Kabloya uygun
- Yay baskılı bağlantı sistemi
- Tek noktadan test imkanı
- Sola döndürerek demontaj

- Suitable for 1,5 - 2,5 mm² cross-sections
- Cage clamp connection
- One-point test
- Disassembling by turning the cable left



Anma Değerleri / Electrical Ratings	Gerilim / Akım / Kesi t/ Voltage / Current / Cross-section								
IEC 60998-1, IEC 60998-2-1 (VDE)	450 V / 24 A / 2,5 mm ²	450 V / 24 A / 2,5 mm ²	450 V / 24 A / 2,5 mm ²						
Boyutlar / Dimensions (a,b,c)	9,4 - 19,4 - 13,8	9,4 - 19,4 - 17,6	9,4 - 19,4 - 21,1						
Bağlantı Bilgileri / Connection Data									
Tekli İletken / Solid Strand	1,0 - 2,5 mm ²	1,0 - 2,5 mm ²	1,0 - 2,5 mm ²						
Sipariş Bilgileri / Ordering Data	Tip/Type	Sip.No./Cat.No.	Mik./Qty.	Tip/Type	Sip.No./Cat.No.	Mik./Qty.	Tip/Type	Sip.No./Cat.No.	Mik./Qty.
	BUK 2,5 / 3	425 235	100	BUK 2,5 / 4	425 245	100	BUK 2,5 / 5	425 255	100